



# HOSHIZAKI

## ADVANCE MD K 100 BG N E Multideck refrigerator with Black and Clear Glass End Panels



PRODUCT SERIES: ADVANCE MD 100  
ITEM NUMBER: 201103150  
COUNTRY OF ORIGIN: TURKEY  
BRAND: ADVANCE

Hoshizaki Advance MD K 100 BG N E is a 970 mm wide open multideck refrigerator with a shelf load capacity (max) of 65 kg ranking in energy efficiency class D. It has a cabinet height of 2000-2018 mm including levelling feet and depth of 750 mm.

- Ventilated refrigeration system
- Air circulation system
- Night blind with soft-close feature
- Replaceable end panels
- Tempered and durable glass upstand at front side
- Tempered and durable glass side panels (HG and BG models)
- Exterior and interior of stainless steel AISI 304
- Stainless steel adjustable shelf supports (adjustable by max of 2 levels)
- Shelves can be moved two levels up or down (level distance is 25 mm)
- 4 optional angle positions of shelves from horizontal to a max of 75° angle
- LED lighting integrated underneath each shelf
- Control module can be pulled out at the front side
- Automatic defrost with re-evaporation of defrost water
- Drainage connection not needed
- Integrated levelling feet (4) and wheels (4)
- IP2X water protection

### ACCESSORIES INCLUDED

4 stainless shelves

### OPTIONAL EXTRAS

Price strips, snack baskets, food tray slides

#### WARRANTY PERIOD

**2 Years on Parts & Labour -  
based on country agreement**

#### EXTERIOR

**Stainless steel AISI 304**

#### INTERIOR

**Stainless steel AISI 304**

Refrigerant type: R290 / Refrigerant: 0.24 kg / CO2 equivalent: 0.72 kg

Energy consumption	Energy efficiency class	Energy efficiency class standard	Energy Efficiency Index (EEI)
4,769 kWh/year	D	ISO 23953-1/2:2023	38.16 EEI

#### CERTIFICATIONS



Hoshizaki Europe B.V.  
Burgemeester Stramanweg 101  
1101 AA Amsterdam  
The Netherlands

HEBV Amsterdam office T. +31 (0)20 691 8499  
Export line direct T. +31 (0)20 565 0429  
[sales.ex@hoshizaki-europe.com](mailto:sales.ex@hoshizaki-europe.com)  
[service.ex@hoshizaki-europe.com](mailto:service.ex@hoshizaki-europe.com)  
[www.hoshizaki-europe.com](http://www.hoshizaki-europe.com)



# HOSHIZAKI

## ADVANCE MD K 100 BG N E

### TECHNICAL SPECIFICATIONS

Temperature (Class: 3M2)	Shelf size	Maksimal hyldebelastning	Volume, gross	Net usable volume	Power supply	Connection load	Climate class	Ref. capacity (at -10°C)
-1/+7°C	W 916 x D 375 mm	350 mm	600 l	435 l	230V, 50 Hz	1,300 W	3 (maximum ambient temperatures of 25 °C with 60% RH)	1,702 W

### SHIPPING SPECIFICATIONS

Width (packed)	Depth (packed)	Height (packed)	Volume (packed)	Gross weight	Width	Depth	Height	Net weight
1,100 mm	1,000 mm	2,150 mm	2.37 m <sup>3</sup>	265 kg	970 mm	750 mm	2,000 mm	235 kg

Disclaimer: Every effort has been made to ensure that the information contained in this spec sheet is accurate at the time of publishing. Hoshizaki Europe BV assumes no responsibility or liability for typographical errors or omissions or for any misinterpretation of the information within the publication and reserves the right to change without notice.

Maximum shelf load	Maximum shelf can load (can = H120 mm x Ø66 mm)	Maximum bottom tray can load (can = H120 mm x Ø66 mm)
65 kg	65 Pc	84 Pc

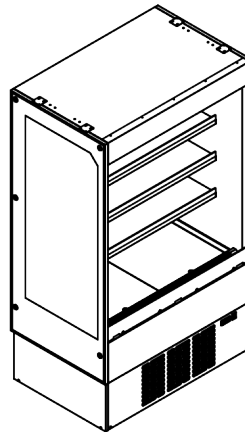
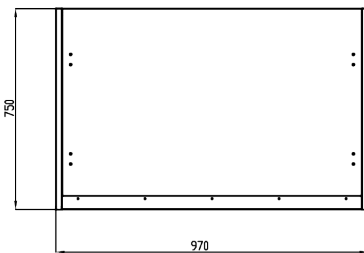
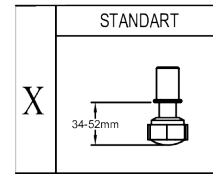
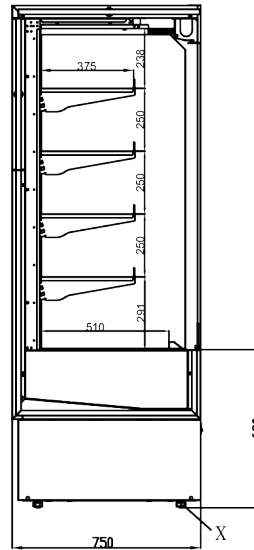
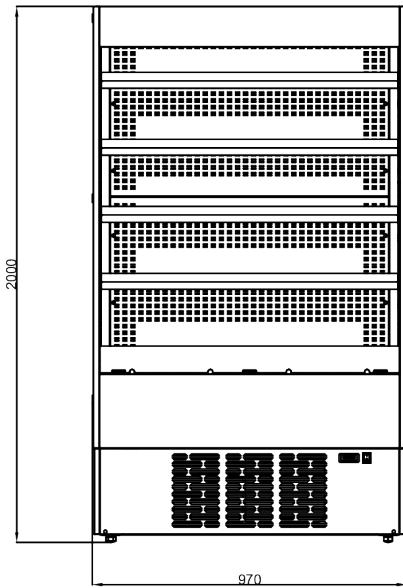

Hoshizaki Belgium  
Hoshizaki Danmark  
Hoshizaki Deutschland  
Hoshizaki France  
Hoshizaki Iberia  
Hoshizaki Italia  
Hoshizaki Middle East

[info@hoshizaki.nl](mailto:info@hoshizaki.nl)  
[info@hoshizaki.dk](mailto:info@hoshizaki.dk)  
[vertrieb@hoshizaki.de](mailto:vertrieb@hoshizaki.de)  
[info@hoshizaki.fr](mailto:info@hoshizaki.fr)  
[info@hoshizaki.es](mailto:info@hoshizaki.es)  
[commerciale@hoshizaki.it](mailto:commerciale@hoshizaki.it)  
[sales.ex@hoshizaki-europe.com](mailto:sales.ex@hoshizaki-europe.com)

Hoshizaki Netherlands [info@hoshizaki.nl](mailto:info@hoshizaki.nl)  
Hoshizaki Norge [salg@hoshizaki.no](mailto:salg@hoshizaki.no)  
Hoshizaki Sverige [orderSE@hoshizaki.dk](mailto:orderSE@hoshizaki.dk)  
Hoshizaki UK [uksales@hoshizaki.uk](mailto:uksales@hoshizaki.uk)  
Export countries [sales.ex@hoshizaki-europe.com](mailto:sales.ex@hoshizaki-europe.com)  
Other countries [sales.ex@hoshizaki-europe.com](mailto:sales.ex@hoshizaki-europe.com)

[www.hoshizaki-europe.com](http://www.hoshizaki-europe.com)